

# RS510 INSTRUCTIONS

TO BE INSTALLED BY A CERTIFIED MECHANIC ONLY | FOR RACE USE ONLY

## BRAKE SIDE EXPLODED VIEW

FOR: SUZUKI GSXR1000 05-06



### INDEX



Lubricate



Red Thread Lock



DO NOT Overtighten



Use Factory Piece

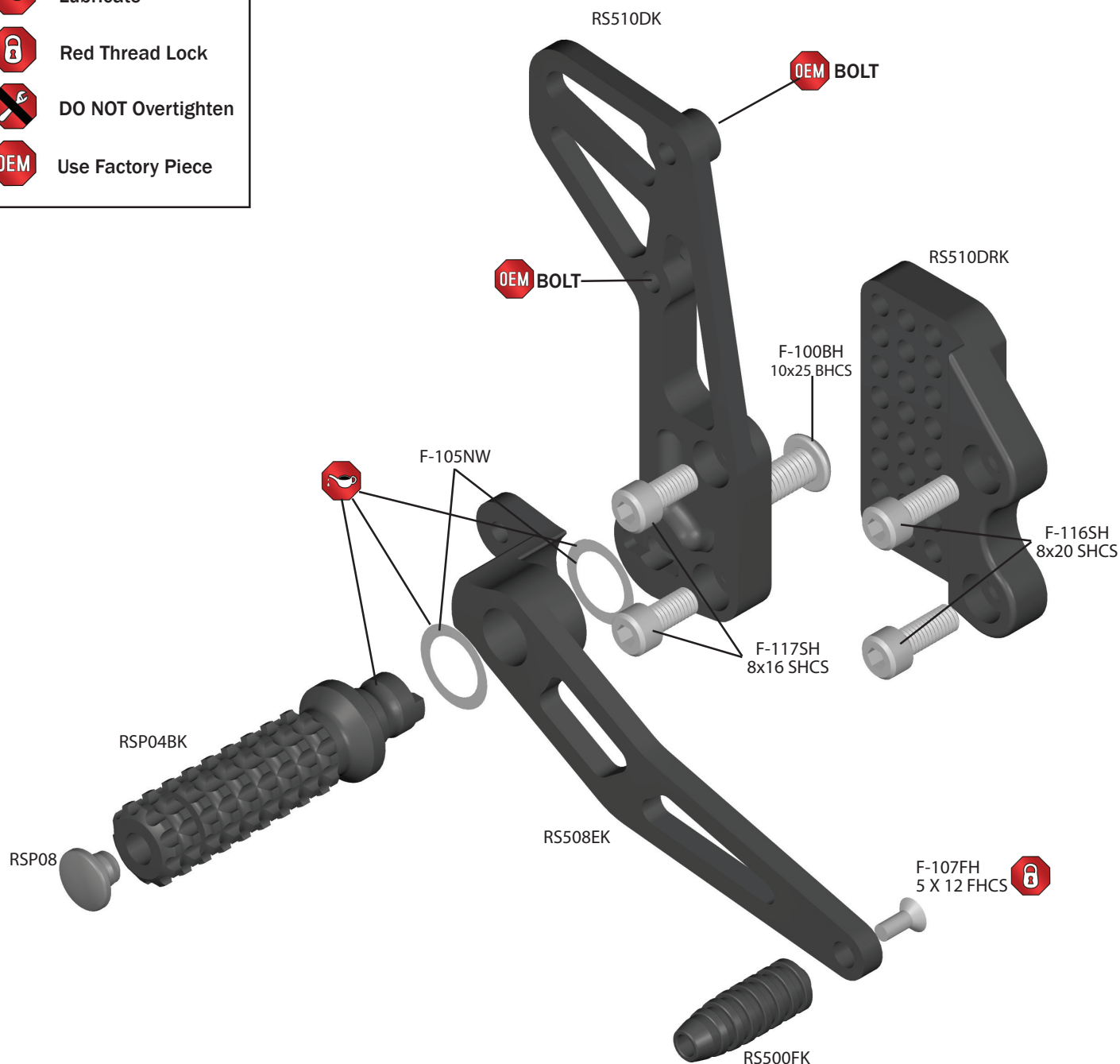

1.800.440.3559

www.VORTEXRACING.com

### BRAKE LIGHT INFO:

These rearsets do not use: OEM rear brake light switch, spring & lever return spring. In race form these rear sets no longer activate rear brake light from rear brake lever. Street use requires rear brake light to be activated by rear & front brake levers. To achieve rear brake light activation from rear brake lever use Vortex in-line pressure switch RS100.



MADE IN  
THE USA

# RS510 INSTRUCTIONS

TO BE INSTALLED BY A CERTIFIED MECHANIC ONLY | FOR RACE USE ONLY

## SHIFT SIDE EXPLODED VIEW

FOR: SUZUKI GSXR1000 05-06



### INDEX



Lubricate



Red Thread Lock



DO NOT Overtighten



Use Factory Piece

RS510AK

F-100BH  
10x25 BHCS

RS510ARK

F-105NW

F-116SH  
8x20 SHCS

F-117SH  
8x16 SHCS

RSP04BK

RSP08

RS508BK

F-107FH  
5 X 12 FHCS



RS500FK



1.800.440.3559

[www.VORTEXRACING.com](http://www.VORTEXRACING.com)

